

Multipoint Hardware System Terminology

1. Trim Maintenance:
Use water to clean and a soft cloth. Do not use brass cleaner as it will remove the protective coating.
2. Profile Cylinder:
Cylinders are available in rekeyable version in Schlage C and Weiser 5 pin keyways. Key blanks are available at most hardware stores.

TERMINOLOGY:

1. Top Shoot bolt
2. Bottom Shoot bolt
3. Deadbolt
4. Mishandling Device
5. Latch Bolt
6. Cylinder Hole
7. Handle Hole
8. Lock case
9. Drive Rail
10. Faceplate
11. Screw Support
12. Tongue
13. Roller
14. Auto-Release Pin
15. Top Extension
Phillips Machine
Screw

Note:

All options are shown for the sake of terminology. The gear system you have will NOT contain all of the components as shown in the diagram below.

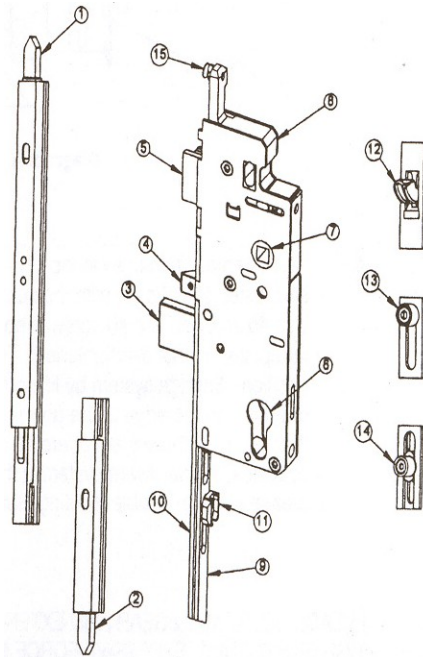

Troubleshooting Guide Multipoint Swing Door Hardware

Be certain door is square in frame before adjusting other hardware. With the door in the open position, engage system by depressing mishandling device, lifting handle and extend deadbolt by turning thumb turn. If the system operates on the door edge and the deadbolt operates, the hardware system is fully functional.

1. SYSTEM WILL NOT OPERATE WHEN YOU LIFT THE HANDLE

Probably Cause: Improper installation of handle set.

Solution: Remove handle and reinstall. See Handle Set Installation Instructions.

2. SYSTEM OPERATES IN THE OPEN POSITION WHEN YOU LIFT THE HANDLE BUT NOT IN THE CLOSED POSITION WITH THE DOOR SHUT

Probably Cause: Relationship of door in the frame.

Solution: Check to make sure the door is square in the frame.

Probably Cause: If automatic version, the auto release pin may not be adjusted properly.

Solution: See Hardware Adjustment Sheet.

3. LOCKING POINTS WILL NOT ENGAGE WITH DOOR SHUT

Probably Cause: Deadbolt is not fully extending.

Solution: Clear away anything blocking travel of deadbolt (insulation, wood, etc.).

4. DEADBOLT WILL NOT FULLY ENGAGE

Probably Cause: Locking points are not fully engaged. System design does not permit deadbolt operation unless locking points are fully engaged.

Solution: Check system again for binding problems. Confirm deadbolt extends fully into strike. Check to confirm locking points are correctly engaging strikes on the frame.

5. THUMBTURN OR KEY WILL NOT TURN

Probably Cause: Back plates may not be on straight.

Solution: Confirm that inside and outside holes line up with lock case. Loosen back plate screws ½ turn.

Swing Door Handle Operation Instructions

Handles and back plates vary in style.

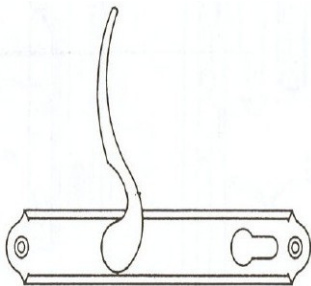

To lock door, push door closed to engage latch.

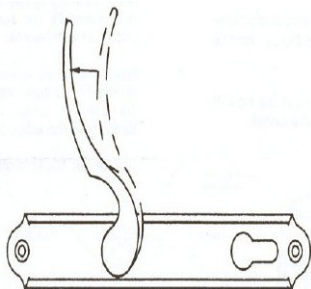

To lock manual system, lift handle to engage multipoints prior to engaging deadbolt.

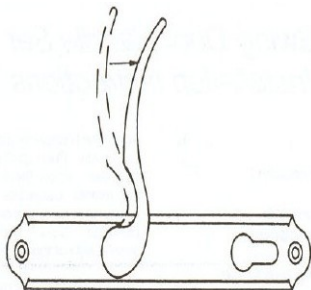

To open, disengage deadbolt with key or thumb turn, push handle down to stop and then open door

Use key or thumb turn to engage deadbolt.

Hardware Modification Instruction Sheet

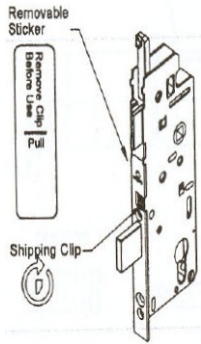
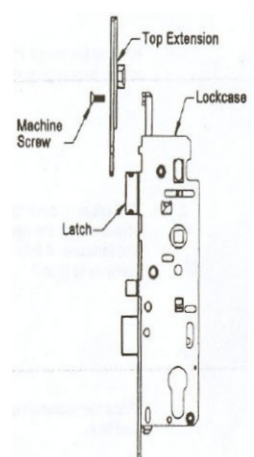
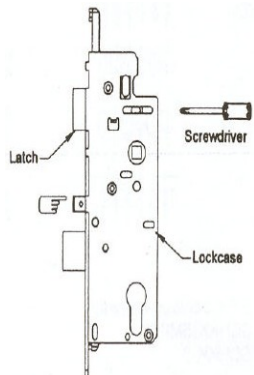
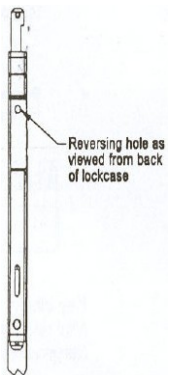
Shipping Clip for Mishandling Device	Attachment
<div style="display: flex; align-items: center;">  <div style="margin-left: 20px;"> <p>Reversing Mishandling Device in Field:</p> <ol style="list-style-type: none"> 1. Remove sticker 2. Remove shipping clip 3. Make sure mishandling device is sloped the same as latch. 4. If not, pull out and spin 180° to the same direction. <p>Reversing Mishandling Device in Factory:</p> <ol style="list-style-type: none"> 1. Remove shipping clip 2. Pull out mishandling device to spin to slope the same as latch. 3. Push mishandling device in and snap shipping clip back in. </div> </div>	<div style="display: flex; align-items: center;">  </div>
<div style="display: flex; align-items: center;">  <div style="margin-left: 20px;"> <p style="text-align: center;">Reversing Latch</p> <ol style="list-style-type: none"> 1. Push small screwdriver or punch into reversing hole and push latch up until latch clears lock case. 2. Rotate latch 180° and release back into lock case. <p style="text-align: center;">Reversing Mishandling Device</p> <ol style="list-style-type: none"> 1. Pull and rotate mishandling device 180° with hand and release back into lock case. </div> </div>	<div style="display: flex; align-items: center;">  </div>